

Good Neighbor Program

Shawnee is an active and vibrant community. Our neighborhoods are a mixture of diverse people, businesses, schools, and residences. This is one of the reasons that Shawnee is such a great place to live, work, and raise a family.

Getting to know your neighbors and becoming a part of the community can be a rewarding experience. Here are a few tips for being a good neighbor in Shawnee:

Know your neighbors.

Simply saying hello or greeting them with a wave can be a good way to begin building neighborly connections.

Be courteous and respectful.

Consider the differences in lifestyles between neighbors, such as family situations (small children, teenagers, retired, elderly, professionals, and students), different work and sleep schedules, and whether they are comfortable with pets or not.

Communication is key.

Talking to neighbors can go a long way in building neighborhood relationships. Ask questions if you aren't sure when you are scheduled for trash collection or ask about recycling, yard maintenance, and more. If you're planning to have guests, ask about parking or noise that may be intrusive. Opening the line of communication can prevent minor concerns or issues from turning into major conflicts between neighbors.

Lend a helping hand.

If you notice litter in a neighbor's yard, ask if they need help picking it up. If an elderly neighbor can't rake the leaves in their yard or clear the ice from their porch or sidewalk, help them out.

Neighbors Helping Neighbors.

If you are interested in volunteering to help someone in need of a helping hand (due to their age or disability), contact the City's Volunteer Coordinator at (913) 742-6244.

Follow city ordinances and HOA regulations.

Making sure you adhere to city ordinances is crucial to good neighborhood relations. If you live in a neighborhood with a Homeowners Association, make sure you follow those regulations also.





These are a few things you can do to be a good neighbor. Many of these items are included in the Shawnee Municipal Code (SMC)..

Animals

Be a responsible pet owner. Maintain vaccinations, prevent excessive pet-related noise, restrain pets in an appropriate manner, and remove pet waste. You may keep a maximum of two cats and a maximum of two dogs without any type of city permit. Any additional pets require a special animal permit. Details on pet regulations can be found in Title 6 of the SMC or you can contact your City Clerk's Office at (913) 742-6014.

Block Parties

Meet your neighbors by hosting a block party. You can obtain a block party permit up to two weeks prior to the scheduled event by completing the Block Party Request Form on the City's website. You must furnish your own road barricades. For questions on block parties, contact your Police Department at (913) 631-2150.

If you would like to host the Shawnee Fire Department at your block party, call (913) 631-1080. Pending availability, a fire truck will be dispatched to the block. Children can get inside the fire truck and learn about the different tools and equipment on the truck.

Cold Weather

Your neighbors use public sidewalks to exercise, go to school, or access local stores or services. People with disabilities rely on them to take care of their day to day activities. Snow and ice can make a sidewalk difficult and dangerous to use and people sometimes resort to walking in the street to reach their destinations. As a reminder, the owner and/or occupant of a property adjacent to a public sidewalk is required to remove snow or ice from the abutting sidewalk within 48 hours after it has stopped falling (SMC 12.06.230). For more information on snow and ice removal from sidewalks, contact your Code Enforcement Office at (913) 742-6210.

To ensure our employees can safely remove/plow snow and ice, please do not park vehicles on the streets. Park in your driveway and don't allow your vehicles to extend into the roadway. If your vehicle is parked on narrow streets, hills, or both sides of the street, the City may not be able to clear snow from your street. Your basketball goals, hockey goals, skateboard ramps, or other structures should be placed at least 10 feet back from the street to allow our employees to safely remove/plow snow and ice.

Fences

Your fence should not exceed six feet (6') in height. No solid fence over 4½ feet high is allowed in a front yard area (a corner lot has two front yards) and no solid fence over 3 feet high is allowed on corner lots within the sight distance triangle of 25 feet (Figure 1).

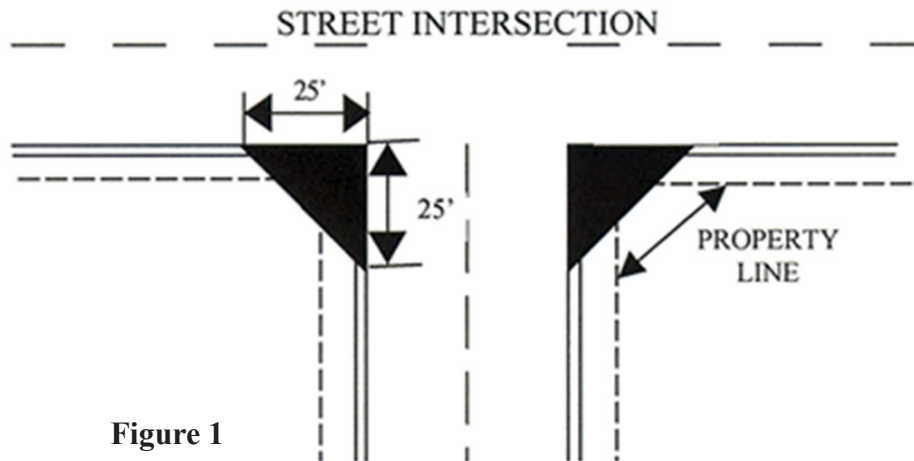

Figure 1

Your fence must be constructed with the finished side facing outward from your property and kept in good condition. Fence regulations can be found in Section 17.60.030 of the SMC or by contacting your Code Enforcement Office at (913) 742-6010.

Garage Sales

We do not issue or require a permit for garage sales. You are allowed two garage sales per calendar year at your residence. City ordinance allows for sales lasting up to five days between the hours of 8:00 a.m. and 8:00 p.m. Garage sale signs are permitted as long as they are not located in public right-of-way and are taken down one day after the sale. More information about garage sales can be found in Chapter 5.32 of the SMC or by contacting your City Clerk's Office at (913) 742-6014.

Noise

Keep noise to an acceptable level. Complaints about excessive noise can come from loud music, outdoor activities, early morning lawn mowers, and guests coming or going during late night or early morning hours. More information about noise levels can be found in Chapter 9.70 of the SMC. If you have a noise complaint, contact your Police Department at (913) 631-2150.

Outside Storage

Items such as, but not limited to, lawn mowers, yard tools, buckets, and other miscellaneous items must be located within a fully enclosed structure or in your backyard and substantially screened by the equivalent of a 6' solid board fence from view of your neighbors. Storage items, including, but not limited to, gardening equipment, vehicle parts, ladders, or wheelbarrows should not occupy more than 20% of the rear yard area. Firewood, not to exceed one cord (4' x 4' x 8'), may be stored outside of the shielded storage area and should be neatly stacked and no closer to the street than the nearest primary wall surface of the residence. If you have concerns about outside storage, contact your Codes Enforcement Office at (913) 742-6010.

Over-Occupancy

No more than four unrelated occupants are allowed to live in your home. The number of occupants allowed to reside in a residence is regulated by zoning district. Many neighborhoods are zoned primarily for single-family. Find out how your residence is zoned by contacting the Community Development Department at (913) 742-6011.

Parking

Please be courteous when parking on neighborhood streets. The City regulates vehicle parking. Parking in yards, on sidewalks, and other “No Parking” signed areas is prohibited. Vehicles parked on the street must be moved every 48 hours. Be aware of your vehicle’s position so that your neighbors can back out of their driveway safely and allow at least 10 feet width of the street so adequate distance can be maintained for emergency vehicles. Vehicles may not be parked within six feet (6’) of any mailbox.

Recreational vehicles, including boats, campers, and trailers can be stored – one per residence – on the side or rear yard (not between the house and the street), and are required to be stored on a concrete, asphalt or paved brick parking pad that is at least the same size as the vehicle. These items may also be stored on the front driveway of a home for not more than 4 days in a 30-day period to allow for trip preparation.

Parking regulations are found in Chapter 10.20 of the SMC. For more information on parking restrictions, contact your Code Enforcement Office at (913) 742-6210.

Recycling, Trash and Yard Waste

Keep Shawnee clean and green. Trash and recycling services are provided to residents by private companies licensed by the City. Recycling and trash can be set out up to 24 hours prior to pick up. Empty containers should be removed within 12 hours of collection. Visit the City’s Trash and Recycling FAQ¹ website or contact your City Manager’s Office at (913) 742-6213.

The City requires all licensed residential haulers to have at least one large item pick up date during the year called “Tidy Town.” They are generally between at the end of April and the beginning of May each year.

¹ https://www.cityofshawnee.org/residents/trash_collection_recycling_and_yard_waste

Soliciting

A permit is not required to solicit in the City. Persons working for non-profit organizations, charitable contributions, census takers, or political candidates or their agents are not considered solicitors. Solicitation is allowed between 10:00 a.m. and 7:00 p.m. The City Clerk’s office has free “No Solicitors” stickers. Solicitors are not allowed to solicit at home or businesses that are posted with a “No Solicitor” sticker or “No Trespasser” sign. Soliciting regulations are found in Chapter 5.56 of the SMC or by contacting your City Clerk’s Office at (913) 742-6014. If you are ever concerned about your safety, call 911.

Stormwater Pollution Prevention

“Only Rain Down the Drain”. Help prevent the pollution of local water systems by not dumping chemicals, yard waste, grass clippings, or other pollutants into the storm drainage system. Yard waste – including grass clippings – clogs drains, pollutes lakes and streams, and causes harm to the ecosystem. Stormwater drainage pollution regulations are found in Section 11.12.040 of the SMC. To report an illegal discharge of pollutants, contact your Stormwater Management Division at (913) 742-6009.

Yard Maintenance

Yard maintenance is the responsibility of every owner or occupant and includes the maintenance of plant and grass material in any public right-of-way abutting the property. In all areas, except properties zoned agricultural, grass must be maintained at a height not to exceed eight inches. Vegetation and trees should be trimmed so as not to impair vision or obstruct travel of motorists or obstruct pedestrian travel on sidewalks. Trees over the public right-of-way or sidewalks should be trimmed up to a height of 14 feet. Ground cover such as grass should be provided for all areas where soil is exposed. Shrubs and hedges should be neatly trimmed and maintained. It is illegal for anyone to deposit yard waste of any kind into the streets, curbs, gutters, creeks, or streams (SMC 11.12.040). For more information on yard maintenance, contact your Code Enforcement Office at (913) 742-6210.